

154
DP
774695

3
DP
1068679

2
DP
1050870

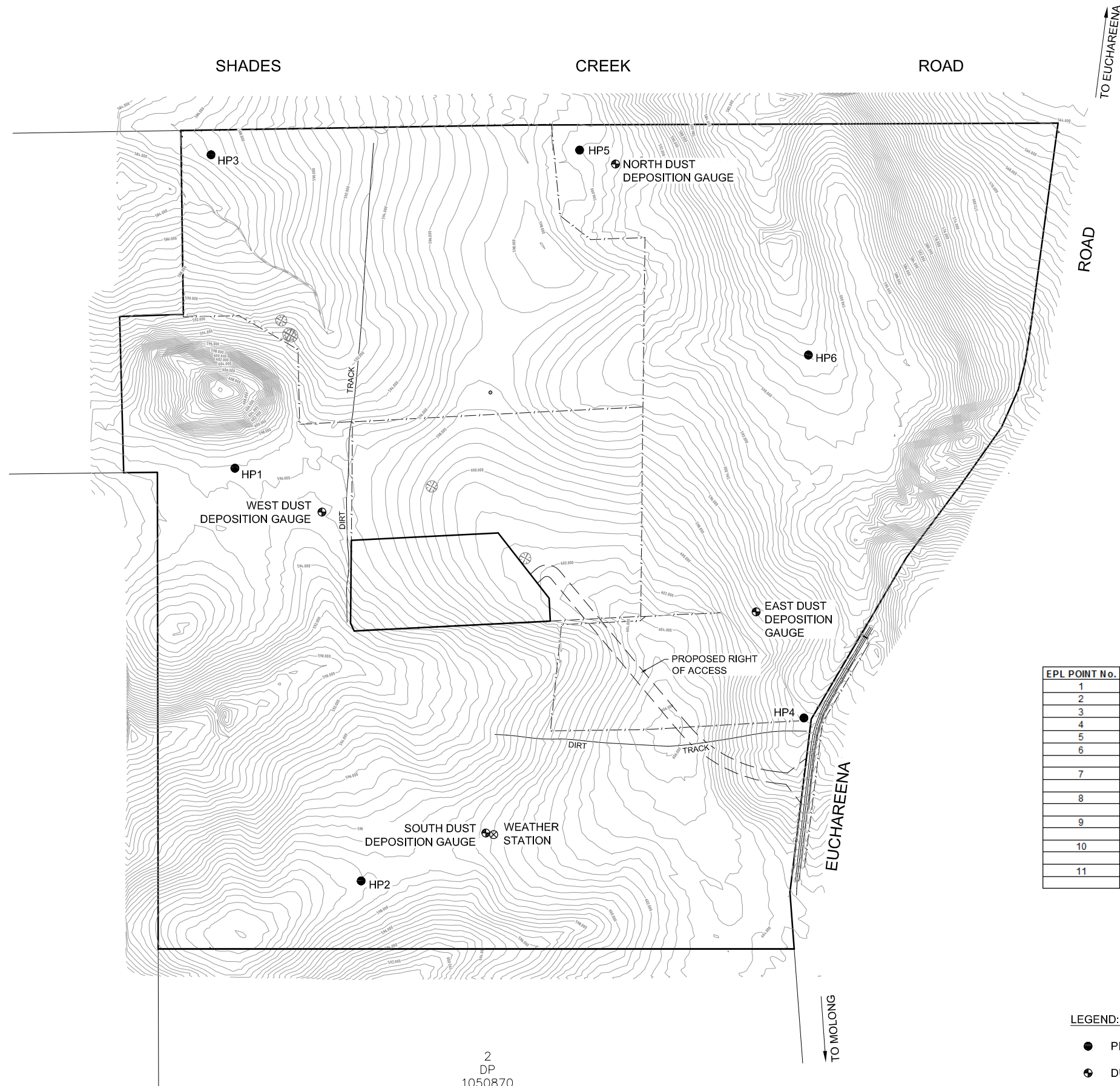

EPL POINT No.	ID	EASTING	NORTHING	R.L.	DETAILS
1	NORTH DDG	67817.1	634145.3		
2	EAST DDG	67825.6	634063.7		
3	SOUTH DDG	67771.9	634035.1		
4	WEST DDG	67754.7	634095.9		
5	WEATHER STATION	67772.6	634034.8		
6	HP1	677413.1	6341064.4	597.37	TOP OF LID
	HP1			596.65	NS
7	HP2	677485.8	6340313.561	600.19	TOP OF CONDUIT
	HP2			599.84	NS
8	HP3	677481.3	6341609.6	586.97	TOP OF LID
	HP3			586.56	NS
9	HP4	678300.9	6340438.719	595.54	TOP OF LID
	HP4			594.92	NS
10	HP5	678114.3	6341489.4	596.93	TOP OF LID
	HP5			596.26	NS
11	HP6	678435.027	6341058.7	588.82	TOP OF CONDUIT
	HP6			588.47	NS

NOTE:
ALL COORDINATES ARE MGA ZONE 55
AND ALL LEVELS ARE TO AHD

LEGEND:

- PIEZOMETER
- ⊕ DUST DEPOSITION GAUGE
- ⊗ WEATHER STATION

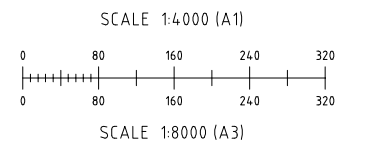

GEOLYSE
ORANGE
154 PEISLEY STREET
P.O. BOX 1963
ORANGE, NSW 2800
orange@geolyse.com
www.geolyse.com
Ph. (02) 6393 5000
Fx. (02) 6393 5050

No	DATE	DRAFTING CHECK	PM CHECK	DETAILS
A	17/05/12	LRP	KBF	ISSUED TO CLIENT
B	29/05/12	LRP	KBF	EPA POINT Nos UPDATED
C	29/06/12	MDH	KBF	LOT DETAILS MODIFIED

PROJECT
EUCHAREENA ROAD RESOURCE RECOVERY CENTRE
FILE REFERENCE: 208212_49C_EV01.dwg

APPROVAL AUTHORITY
ENVIRONMENT PROTECTION AUTHORITY

CLIENT

DRAWING
EPL 20104 MONITORING POINTS FIGURE 1
PROJECT NUMBER: 208212 DRAWING NUMBER: 49C_EV01 REV: C
SOURCE: INTERNAL